



**First Real Waterproof
3 inch Thermal
POS Printer**

SRP-F310



The SRP-F310 is a 3 inch thermal POS printer based on the technical power of the SRP-350 Series that is widely recognized in the market for its credibility and performance. It supports a printing speed of 270mm/sec and 180dpi/203dpi resolution and is a waterproof printer that acquired IPX2 Class. The SRP-F310 is suitable for kitchens, restaurants and all the other applications that require a waterproof function and has the advantage of supporting various interfaces.

HIGHLIGHTS

- Liquid-Barrier™ front exit printer (IPX2 Class certified)
 - Downpour water resistance
 - Water resistant up to 15 degree from vertical
- All in one plus™ Interfaces
 - Ethernet + USB port + USB + Serial or Parallel all in one!
 - Ethernet interface on board standard
 - USB host port on board for WLAN dongles standard
 - High speed (480 Mbps) USB 2.0 on board standard
 - Interchangeable interface card ; Serial or Parallel
- Faster printing speed- 270mm/second
 - Optimized mechanical components and software to enable fast and stable printing
 - Improved CPU (333 MHz) and Larger memory (256k byte)
- Larger paper roll diameter up to 105mm
 - Reduces paper changes by 50% with support for 105mm rolls
- Optional BIXOLON Interactive Linker
 - Programmable choice using 4 buttons
 - Receipt on demand printing / Cash drawer open / Printing stop / Signal back to host POS etc..
- Built-in Power Supply
 - An ideal design for compact counters and highly traffic cashier desks
- User-convenience design
 - Click-in, Click-out cover for easy maintenance (Dip Switch / SMPS / Main Board)
 - Easy replacement of TPH and Auto-Cutter
 - Adjustable paper width guide (80mm or 83mm)
- Ergonomic design front control panel
 - Additional front angle for ergonomic design
 - High-gloss front panel to allow easy LED status check
 - Three LEDs, Paper / Power / Error
- Eco-friendly printer
 - Smallest margin (Auto-Cutter <-> TPH : 9mm) reduces unused paper
 - PowerSaver™ with BIXOLON Windows driver
- Full featured BIXOLON POS Software Package (PSP)
 - Smart unified Windows driver
 - Advanced design tool included Image Rotate, Reverse printing and Text Macro / Margin crop
 - Intelligent Interface auto-installer
 - Automatic setting for interfaces even Serial baud rate
 - Advanced Utility
 - Font Artist™
 - Water-mark tool

PRODUCT FEATURES

Liquid-Barrier™ front exit printer

The SRP-F310 is a front exit type receipt POS printer adapting structure for preventing liquid infiltration and certified under the electrical protection level, IPX2 Class. Its design components include an exterior cover as well as dual layers on both sides of the printer which discharge liquid preventing it from infiltrating inside. In addition, it is designed with an outlet at the bottom of the printer for liquid that may seep inside through the cover open button.

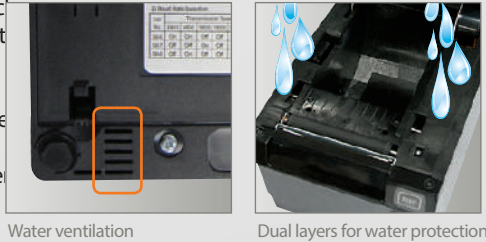

All in one plus™ interfaces

The SRP-F310 features a powerful interface that goes beyond your imagination of what you are looking for in a receipt POS printer. It includes USB 2.0 On board for fast data transfer and USB host port for the use of WLAN dongle and Ethernet, which is sold separately at a high price. The four interfaces are provided as a built-in feature. Selectable Interfaces are Serial and Parallel.

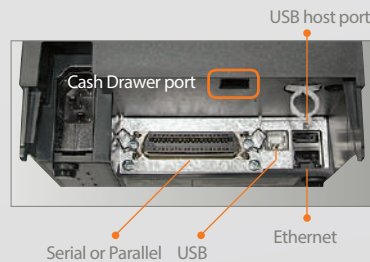

* WLAN dongle : The SRP-F310 is compatible with WLAN adapters using the Ralink RT73 chipset. WLAN USB adapters using chipsets other than Ralink RT73 won't work when they are connected to the SRP-F310.

Optional BIXOLON Interactive Linker

BIXOLON Interactive Linker is an advanced printer option that allows users to add commands to four customizable buttons. For instance, they can assign such BIXOLON Interactive Linker based programs as "Receipt on Demand", "Cash Drawer Open", "Printing Stop" and "Signal Back to Host" to each button to accommodate their needs.

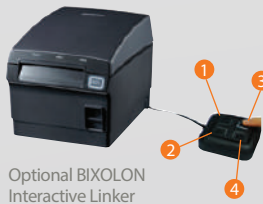

Built-in power supply

The power adapter is elegantly integrated into the compact printer housing. Consequently, messing around with cables is avoided which is ideal at space-limited POS terminals or highly frequented cash desks.

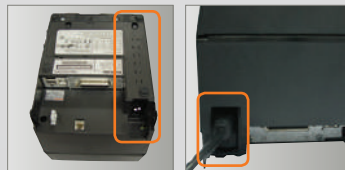

Ergonomic design front control panel

BIXOLON SRP-F310 is designed in a pentagon shape with separate angles for the control panel unlike existing front exit type receipt POS printers. This ergonomic design allows users to check the printer status more conveniently and eliminates the need to open a drawer to check the status for those who keep the printer in a drawer.



High-gloss front panel with three LEDs



IPX2 Class certified

SPECIFICATIONS

PRINT

PRINTING METHOD : Direct thermal
 PRINTING SPEED : 270mm/sec
 RESOLUTION : Standard :180dpi(7dot/mm)
 Optional(SRP-F312) : 203dpi(8dot/mm)
 CHARACTER SIZE : Font A: 12 x 24
 Font B: 9 x 17
 Font C: 9 x 24
 Korean/ Chinese: 24 x 24
 CHARACTERS PER LINE :
 Font A : 42 / Font B : 56 / Font C : 56
 CHARACTER SET : Alphanumeric Character : 95
 Extended Character : 128 x 34 pages
 International Character : 32

BARCODES :

1D : EAN-13, EAN-8, Code 39, Code 93, Code 128, ITF, Coda Bar, UPC-A, UPC-E
 2D : PDF417, QR Code

PAPER

WIDTH : 80/83mm
 PAPER ROLL DIAMETER : Max Ø 105mm
 PAPER LOADING : Easy Paper Loading

RELIABILITY

PRINTER UNIT : 70 million lines
 TPH : 150 Km
 AUTO CUTTER : 1,800,000 cuts
 INTERFACE : USB 2.0 and USB host Port for WLAN dongle and Ethernet on board, RS-232C, IEEE1284

RECEIVE BUFFER : 4 Kbytes

NV IMAGE MEMORY : Mono: 256 Kbytes
 Color: 256 Kbytes

USER DEFINE BUFFER : 12 Kbytes

EMULATION : BXL / POS

DRIVER : Windows Driver, OPOS Driver, JPOS Driver, Linux CUPS Driver, Mac Driver

SENSOR : Paper Near End Sensor, Paper End Sensor, Cover Open Sensor

DRAWER PORT : 2 ports

POWER SUPPLY (SMPS) : AC 100-240V / DC 24V, 2.5A

DIMENSIONS : 154 x 203 x 148 (W x L x H mm)

WEIGHT (g) : 2,000

(lbs) : 4.4

OPERATING TEMPERATURE : 0 to 45°C, 10 to 80% RH (non-condensing)

BIXOLON®

BR-SRP-F310-EN-OCT11-V2

Copyright © BIXOLON Co., Ltd. All rights reserved. Features and specifications are subject to change without prior notice.

www.bixolon.com

Contact Us: If you have further enquiries, please contact us for more information & discussion.



milliontech

Million Tech Development Limited

Address: Unit 509, 5/F, Tower II, Cheung Sha Wan Plaza, 833 Cheung Sha Wan Road, Kowloon, Hong Kong

General Line: (852) 2788 3306

Sales Enquiry: (852) 2784 2868

Service Hotline: (852) 2784 2888

F a x : (852) 2319 2967

Email: sales@milliontech.com

Email: helpdesk@milliontech.com

Website: https://milliontech.com